



## Continuous Sleevewrapper

# SUPER WRAP 800 SERVO

**Stacked products with high speed (up to 50 cycles/min) sleevewrapping.**

This absolutely new conceived sleevewrapper has assumed a lot from the already known and successful SUPER WRAP-types. But very new is the fact that this machine packs without STOP and GO of the products, thus in continuous motion with up to 50 cycles/minute.

The machine was especially conceived for the economical transport-packaging of newspaper and magazine-stacks or for any other printing products and gives new range of performance. The servo technology comes from the successful type UNIVERSA 500 SERVO.

Principal customers of this new high-performance sleevewrapper are publishing companies, shipment services etc. and everywhere where film packing of printing products with high capacity is needed. Another operational area are accumulative-packs from the dairy-, convenience- or food-sector, in general where 50 cycles from the sleevewrapper are required. A technical goody is the control with SIMOTION D410 with MOTION CONTROL from SIEMENS. With the new SUPER WRAP 800 SERVO you are ahead not only due to the packaging capacity, but also thanks to its control technique.



**Kalfass**  
Verpackungsmaschinen

Results count.

## Facts, data, figures

### Technical Data

operator interface :	Touchpanel SIEMENS TP 177 incl. Product Data Memory for various products
programmable logic controller (PLC)	SIEMENS S7
sealing system:	permanently heated seal bar with exchangeable sealing ledge in profile contour, maintenance free, with absolutely inodorous operation, temperature regulation by PLC
clearance in width:	800 mm
clearance in height, adjustable:	100 - 400 mm
product weight, min. approx.:	1,5 kg
product length, min. approx.:	120 mm
film:	flat film, up to approx. 80 micron
outside diameter of film reel, max.:	400 mm
width of film reel, max.:	750 mm top roll; 750 mm bottom roll
power supply:	400 volts, 50 Hz, 3-phase, with protective earth conductor
rated capacity:	6.0 kVA
nominal current at 400 V:	8.7 amps
operating side:	left hand side in working direction
working height, adjustable:	850 - 950 mm
colour:	KALLFASS Anthracite
fully-automatic product infeed by means of an in-line transport conveyor	
permanently heated seal bar, electromotorically operated, with exchangeable sealing ledge	
seal bar equipped with safety device to protect sensitive products as well as for optimum operational safety	
operator guidance and error diagnostic by Touchpanel SIEMENS incl. Product Data Memory for various products	
programmable logic controller (PLC) type SIMOTION D 410 with Motion Control from SIEMENS	
upper and lower film reel motor-driven	
film tear and film end control	
infinitely adjustable speed of both transport conveyors by means of frequency transformer, range of adjustment approx. 10 - 35 m/min, incl. smooth-start	
transport conveyor in the outfeed area	
extensive safety guarding	

### Options at extra cost

free rotating counter seal bar (without wear parts such as Teflon tape or Silicone)
electrical lifting device for easier handling of heavy film reels up to a weight of 80 kg, with swivel mechanism, incl. stand-by film reel station on top
film low control, upper and lower film roll
stand-by film reel station for bottom reel, laterally extensible (indicate feeding side!)
machine on castors for mobility (differing working height!)
special colour (structure lacquer, monochromatic)
special voltage (for standard voltage see technical data)
spare parts kits

### Machine dimensions (approx. in mm):

(This drawing may show options which are not included in the basic machine version and are available against up-charge only.)

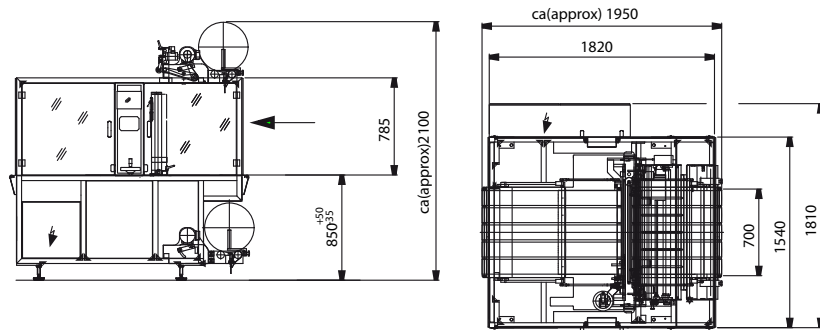

**Kallfass**  
Verpackungsmaschinen

**Kallfass Verpackungsmaschinen GmbH**  
Germany  
Siemensstraße 8 · 72622 Nürtingen-Zizishausen  
Phone +49/7022/607-0 · Fax +49/7022/607-200  
info@kallfass.com · www.kallfass.com

