



## High-Performance Shrink Tunnel

# COMPACT 650 SO

## Stainless Steel Execution

### An All-Rounder for Display Packaging

COMPACT 650 SO shrink tunnels are designed to work with fully-automatic overwrapping machines, such as Kalfass' UNIVERSA 5050, UNIVERSA 400, UNIVERSA 500 SERVO or SERVO JET 400/80, at production speeds of up to 100 packs/min

Due to stainless steel execution the COMPACT SO is the ideal shrinking component in food production lines to achieve high-impact retail packaging for various food products such as pizza, frozen food products in boxes, sausages, egg trays, meat, fish and poultry products or others.

Each COMPACT SO features Kalfass' patented concentric nozzle heating system that ensures a uniform, high-velocity flow of hot air. Quick and even heat transfer shrinks the film to form tight, crease-free packaging. This optimised shrink process consistently achieves display packaging for the highest demands when polyolefin films are used.

A stepless adjustable tunnel blower speed and switchable 2-stage heating system enable the matching of shrink performance to product and film requirements. At the same time this offers the potential for a significant saving in energy.



**Kalfass**  
Verpackungsmaschinen

Results count.

## Facts, data, figures

### Technical Data

### Compact 650 SO

tunnel clearance in width:	650 mm
tunnel clearance in height, adjustable:	100 - 400 mm
length of the heated tunnel hood:	1100 mm
air-flow regulation with patented ring nozzle system:	standard
maintenance free plastic-mesh-belt:	standard
transport speed infinitely variable, frequency controlled:	approx. 10 – 35 m/min.
capacity of the tunnel blower infinitely variable, frequency controlled:	standard
energy saving 2-stage heating with special insulation in tunnel hood:	standard
temperature control by means of electronic thermostat:	switching precision +/- 0.2° C
wear resistant and contactless temperature control:	standard
safety device according to EC regulation machines EN 60204: limit temperature control:	standard
working height, adjustable:	800 - 900 mm
power supply:	400 Volts, 50 Hz, with protective earth conductor
heating capacity, installed, 2-stage switchable:	9.0 + 4.5 kW
rated capacity:	14.5 kVA
nominal current at 400 V:	21.0 amps
total connected load:	max. 37.0 amps (incl. add. three phase power supply)
position of control cabinet and operating side:	left hand side in working direction
colour:	KALLFASS Anthracite

### Options at extra cost

tunnel hood with "clear-view-window" and light inside the tunnel hood (clearance in height, adjustable 200 - 400 mm)
additional insulation hood with clearance in height of fix 200 mm and length 1400 mm (not possible in combination with tunnel hood with "clear-view-window" and light)
weekly program timer on/off automatic with acoustic start warning
machine on/off from packing machine with start acoustic warning
plugs for power and signalling connection with up-stream machine
cool-down automatic, activated by push button, heating will be switched off, tunnel transport and tunnel blower stay in operation
selector switch for packing/transport
lockable cover for operating panel
transport monitoring system by means of contactless initiator direct at the transport, including emergency stop of the heating; with optical indication
machine on castors for mobility (differing working height!)
300 mm cooling station behind the tunnel, consisting of aluminium rollers, running in ball bearings
special cooling blower above product outfeed
special voltage (for standard voltage see technical data)
special colour (structure lacquer, monochromatic)

### Machine dimensions (approx. in mm):

(This drawing may show options which are not included in the basic machine version and are available against up-charge only.)

Compact 650 SO

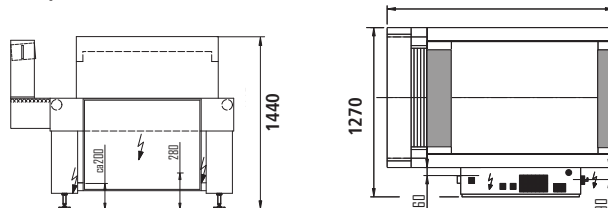

**Kallfass**  
Verpackungsmaschinen

Kallfass Verpackungsmaschinen GmbH  
Germany  
Siemensstraße 8 · 72622 Nürtingen-Zizishausen  
Phone +49/7022/607-0 · Fax +49/7022/607-200  
info@kallfass.com · www.kallfass.com

